

CONTRACT: TIP PROJECT: SS-4912AK

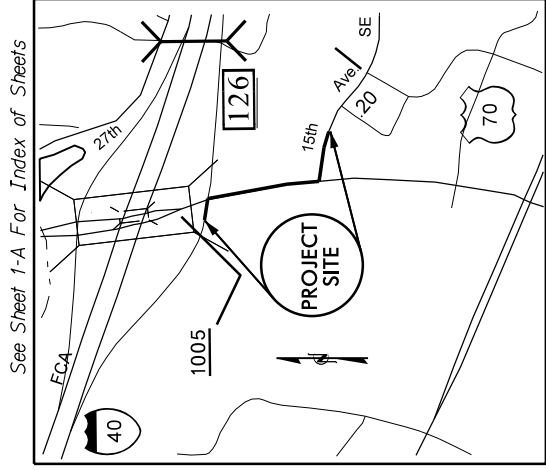

VICINITY MAP: NOT TO SCALE

STATE OF NORTH CAROLINA
 DIVISION OF HIGHWAYS
CATAWBA COUNTY

LOCATION: SR 1005 (McDONALD PARKWAY SE) BETWEEN THE INTERSECTION OF I-40 EAST EXIT RAMP AND SR 3003 (15th AVENUE SE.)
TYPE OF WORK: GRADING, PAVING, CONCRETE ISLAND COVERS, CONCRETE SIDEWALK, CONCRETE CURB & GUTTER, PAVEMENT MARKINGS AND PAVEMENT MARKERS

4

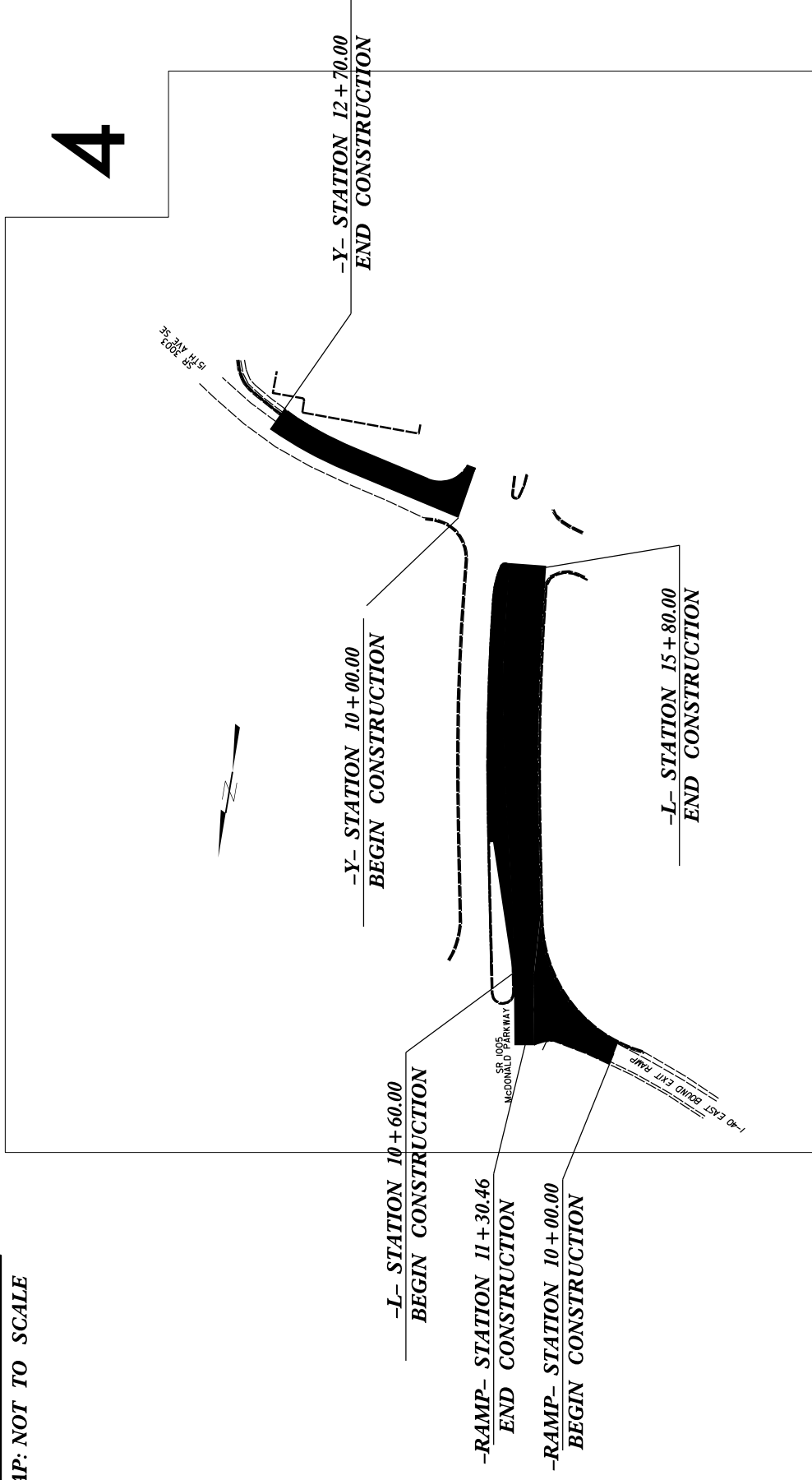

STATE	STATE PROJECT REFERENCE NO.	SHEET NO.	TOTAL SHEETS
N.C.	SS-4912AK	I	1
STATE PROJ. NO.	F.A. PROJ. NO.	DESCRIPTION	
43491.1.1	HSIP-1005(28)	PE	
43491.2.1		ROW	
43491.3.1		CONSTR.	

GRAPHIC SCALES

PLANS

DESIGN DATA

V = 45 MPH
 FUNC CLASS =
 SUBREGIONAL TIER

PROJECT LENGTH

LENGTH OF ROADWAY PROJECT = 0.186 MI
 TOTAL LENGTH OF ROADWAY PROJECT = 0.186 MI

Prepared in the Office of:
DIVISION OF HIGHWAYS
 1000 Birch Ridge Dr., Raleigh NC, 27610

2012 STANDARD SPECIFICATIONS

RIGHT OF WAY DATE: N/A
 LETTING DATE: JULY 24, 2012

M.E. STAFFORD, P.E.
 PROJECT ENGINEER

R.E. HUMPHRIES, PLS
 PROJECT DESIGN ENGINEER

HYDRAULICS ENGINEER

ROADWAY DESIGN ENGINEER

SIGNATURE: _____ P.E.

SIGNATURE: _____ P.E.



2012 ROADWAY ENGLISH STANDARD DRAWINGS

The following Roadway Standards as appear in "Roadway Standard Drawings" Highway Design Branch - N. C. Department of Transportation - Raleigh, N. C., dated January, 2012 are applicable to this project and by reference hereby are considered a part of these plans:

STD. NO.	TITLE
DIVISION 2 - EARTHWORK	
200-02	Method of Clearing - Method II
225-02	Guide for Grading Subgrade - Secondary and Local
225-04	Method of Obtaining Superlevation - Two Lane Pavement
DIVISION 8	
846-01	Concrete Curb, Gutter and Curb & Gutter
846-01	Concrete Sidewalk
848-05	Curb Ramp - Proposed Curb & Gutter
852-10	Median Construction - with Curb and Gutter

GENERAL NOTES:

2012 SPECIFICATIONS
EFFECTIVE: 01-17-12
REVISED: 11/01/11

GRADING AND SURFACING OR RESURFACING AND WIDENING:

THE GRADE LINES SHOWN DENOTE THE FINISHED ELEVATION OF THE PROPOSED SURFACING AT GRADE POINTS SHOWN ON THE TYPICAL SECTIONS. WHERE NO GRADE LINES ARE SHOWN, THE PROFILES SHOWN DENOTE THE TOP ELEVATION OF THE EXISTING PAVEMENT ALONG THE CENTER LINE OF SURVEY ON WHICH THE PROPOSED RESURFACING WILL BE PLACED. GRADE LINES MAY BE ADJUSTED BY THE ENGINEER IN ORDER TO SECURE A PROPER 1% IN.

CLEARING:

CLEARING ON THIS PROJECT SHALL BE PERFORMED TO THE LIMITS ESTABLISHED BY METHOD 11.

SUPERELEVATION:

ALL CURVES ON THIS PROJECT SHALL BE SUPERELEVATED IN ACCORDANCE WITH STD. NO. 225-04 USING THE RATE OF SUPERELEVATION AND RUNOFF SHOWN ON THE PLANS. SUPERELEVATION IS TO BE REVOLVED ABOUT THE GRADE POINTS SHOWN ON THE TYPICAL SECTIONS.

TEMPORARY SHORING:

SHORING REQUIRED FOR THE MAINTENANCE OF TRAFFIC WILL BE PAID FOR AS "EXTRA WORK" IN ACCORDANCE WITH SECTION 104-7.

SUBSURFACE PLANS:

NO SUBSURFACE PLANS ARE AVAILABLE ON THIS PROJECT. THE CONTRACTOR SHOULD MAKE HIS OWN INVESTIGATION AS TO THE SUBSURFACE CONDITIONS.

UTILITIES:

UTILITY OWNERS ON THIS PROJECT ARE DUKE ENERGY CAROLINAS, CHARTER COMMUNICATIONS, CENTURY LINK, ANY RELOCATION OF EXISTING UTILITIES WILL BE ACCOMPLISHED BY OTHERS.

RIGHT-OF-WAY MARKERS:

ALL RIGHT-OF-WAY MARKERS ON THIS PROJECT SHALL BE PLACED BY OTHERS.

CURB RAMPS

CURB RAMPS ARE SHOWN ON THE PLANS AT APPROXIMATE LOCATIONS. CONSTRUCT ALL CURB RAMPS ACCORDANCE WITH STD. 848-05 AND/OR 848-06

INDEX OF SHEETS	SHEET
TITLE SHEET	
INDEX OF SHEETS, GENERAL NOTES, AND LIST OF STANDARD DRAWINGS	1-A
CONVENTIONAL SYMBOLS	1-B
PAVEMENT SCHEDULE, TYPICAL SECTIONS, AND WEDGING DETAILS	2
SUMMARY OF QUANTITIES	3
SUMMARY OF EARTHWORK AND ASPHALT PAVEMENT REMOVAL SUMMARY	3A
PLAN SHEET	4
TRAFFIC CONTROL PLANS	TCP-1 THRU TCP-6
PAVEMENT MARKING PLANS	PM-1 THRU PM-2
EROSION CONTROL PLANS	EC-1 THRU EC-4
CROSS-SECTIONS	X-1 THRU X-2

Note: Not to Scale

*S.U.E. = Subsurface Utility Engineering

STATE OF NORTH CAROLINA
DIVISION OF HIGHWAYS

PROJECT REFERENCE NO.
SS-4912AK

SHEET NO.
7-B

CONVENTIONAL PLAN SHEET SYMBOLS

BOUNDARIES AND PROPERTY:

- State Line
- County Line
- Township Line
- City Line
- Reservation Line
- Property Line
- Existing Iron Pin
- Property Corner
- Property Monument
- Parcel/Sequence Number
- Existing Fence Line
- Proposed Woven Wire Fence
- Proposed Chain Link Fence
- Proposed Barbed Wire Fence
- Existing Wetland Boundary
- Proposed Wetland Boundary
- Existing Endangered Animal Boundary
- Existing Endangered Plant Boundary
- Known Soil Contamination: Area or Site
- Potential Soil Contamination: Area or Site

BUILDINGS AND OTHER CULTURE:

- Gas Pump Vent or UG Tank Cap
- Sign
- Well
- Small Mine
- Foundation
- Area Outline
- Cemetery
- Building
- School
- Church
- Dam

HYDROLOGY:

- Stream or Body of Water
- Hydro, Pool or Reservoir
- Jurisdictional Stream
- Buffer Zone 1
- Buffer Zone 2
- Flow Arrow
- Disappearing Stream
- Spring
- Wetland
- Proposed Lateral, Tail, Head Ditch
- False Sump

RAILROADS:

- Standard Gauge
- RR Signal Milepost
- Switch
- RR Abandoned
- RR Dismantled

RIGHT OF WAY:

- Baseline Control Point
- Existing Right of Way Marker
- Existing Right of Way Line
- Proposed Right of Way Line
- Proposed Right of Way Line with Iron Pin and Cap Marker
- Proposed Right of Way Line with Concrete or Granite RW Marker
- Proposed Control of Access Line with Concrete CA Marker
- Existing Control of Access
- Proposed Control of Access
- Existing Easement Line
- Proposed Temporary Construction Easement
- Proposed Temporary Drainage Easement
- Proposed Permanent Drainage Easement
- Proposed Permanent Drainage / Utility Easement
- Proposed Permanent Utility Easement
- Proposed Temporary Utility Easement
- Proposed Aerial Utility Easement
- Proposed Permanent Easement with Iron Pin and Cap Marker

ROADS AND RELATED FEATURES:

- Existing Edge of Pavement
- Existing Curb
- Proposed Slope Stakes Cut
- Proposed Slope Stakes Fill
- Proposed Curb Ramp
- Existing Metal Guardrail
- Proposed Guardrail
- Existing Cable Guidrail
- Proposed Cable Guidrail
- Equality Symbol
- Pavement Removal

VEGETATION:

- Single Tree
- Single Shrub
- Hedge
- Woods Line

WATER:

- Water Manhole
- Water Meter
- Water Valve
- Water Hydrant
- Recorded UG Water Line
- Designated UG Water Line (S.U.E.*)
- Above Ground Water Line

TV:

- TV Satellite Dish
- TV Pedestal
- TV Tower
- UG TV Cable Hand Hole
- Recorded UG TV Cable
- Designated UG TV Cable (S.U.E.*)
- Recorded UG Fiber Optic Cable
- Designated UG Fiber Optic Cable (S.U.E.*)

GAS:

- Gas Valve
- Gas Meter
- Recorded UG Gas Line
- Designated UG Gas Line (S.U.E.*)
- Above Ground Gas Line

SANITARY SEWER:

- Sanitary Sewer Manhole
- Sanitary Sewer Cleanout
- UG Sanitary Sewer Line
- Above Ground Sanitary Sewer
- Recorded SS Forced Main Line
- Designated SS Forced Main Line (S.U.E.*)

MISCELLANEOUS:

- Utility Pole
- Utility Pole with Base
- Utility Located Object
- Utility Traffic Signal Box
- Utility Unknown UG Line
- UG Tank; Water, Gas, Oil
- Underground Storage Tank, Approx. Loc.
- A/G Tank; Water, Gas, Oil
- Geoenvironmental Boring
- UG Test Hole (S.U.E.*)
- Abandoned According to Utility Records
- End of Information

TELEPHONE:

- Existing Telephone Pole
- Proposed Telephone Pole
- Telephone Manhole
- Telephone Booth
- Telephone Pedestal
- Telephone Cell Tower
- UG Telephone Cable Hand Hole
- Recorded UG Telephone Cable
- Designated UG Telephone Cable (S.U.E.*)
- Recorded UG Telephone Conduit
- Designated UG Telephone Conduit (S.U.E.*)
- Recorded UG Fiber Optics Cable
- Designated UG Fiber Optics Cable (S.U.E.*)

PROJECT REFERENCE NO. SS-49/2AK	SHEET NO. I-C
RAW SHEET NO. ROADWAY DESIGN ENGINEER	HYDRAULICS ENGINEER

CONTROL DATA

POINT	NORTH	EAST	ELEVATION	STATION	OFFSET
1	719571.9610	1319176.0610	1000.00	-Y- 10+33.77	43.56' RT
2	720155.8050	1318934.3120	977.78	-L- 10+86	43.28' RT

CENTERLINE COORDINATE DATA

STATION	ALIGNMENT	NORTH	EAST
10+00	-L-	720247.9020	1318962.7130
10+00	-Y-	719622.0870	1319153.1350
10+00	-RAMP-	720271.5517	1318842.2782

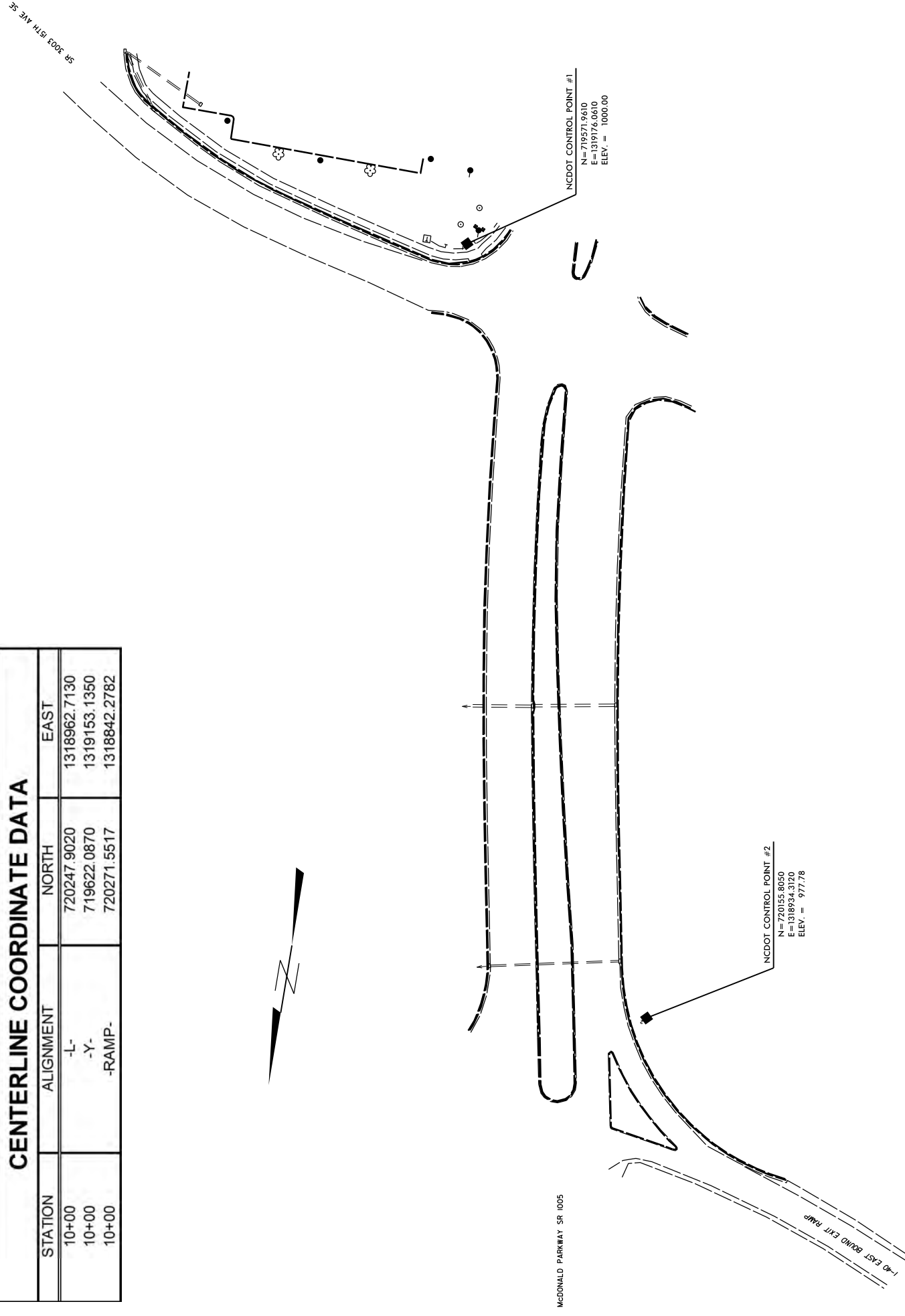

PROJECT REFERENCE NO. SS-49/2AK	SHEET NO. 2
R/W SHEET NO. ROADWAY DESIGN ENGINEER	HYDRAULICS ENGINEER

PAVEMENT SCHEDULE	
C	PROP. APPROX. 1.5" ASPHALT CONCRETE SURFACE COURSE, TYPE S9.5D, AT AN AVERAGE RATE OF 112 LBS. PER SQ. YD.
D	PROP. APPROX. 5.5" ASPHALT CONCRETE INTERMEDIATE COURSE, TYPE I19.0B, AT AN AVERAGE RATE OF 313.5 LBS. PER SQ. YD. FOR EACH OF 2 LIFTS
E	PROP. APPROX. 4" ASPHALT CONCRETE BASE COURSE, TYPE B25.0B, AT AN AVERAGE RATE OF 456 LBS. PER SQ. YD.
R	2'-6" CONCRETE CURB AND GUTTER
R1	4" CONCRETE ISLAND COVER
R2	4" CONCRETE SIDEWALK
R3	1'-6" CONCRETE CURB AND GUTTER
U	EXISTING ASPHALT PAVEMENT.
U1	EXISTING CONCRETE CURB AND GUTTER.
V	MILLING BITUMINOUS PAVEMENT 1.5" DEPTH.
W	WEDGING
Y	INCIDENTAL STONE BASE

NOTE: PAVEMENT EDGE SLOPES ARE 1:1 UNLESS SHOWN OTHERWISE.

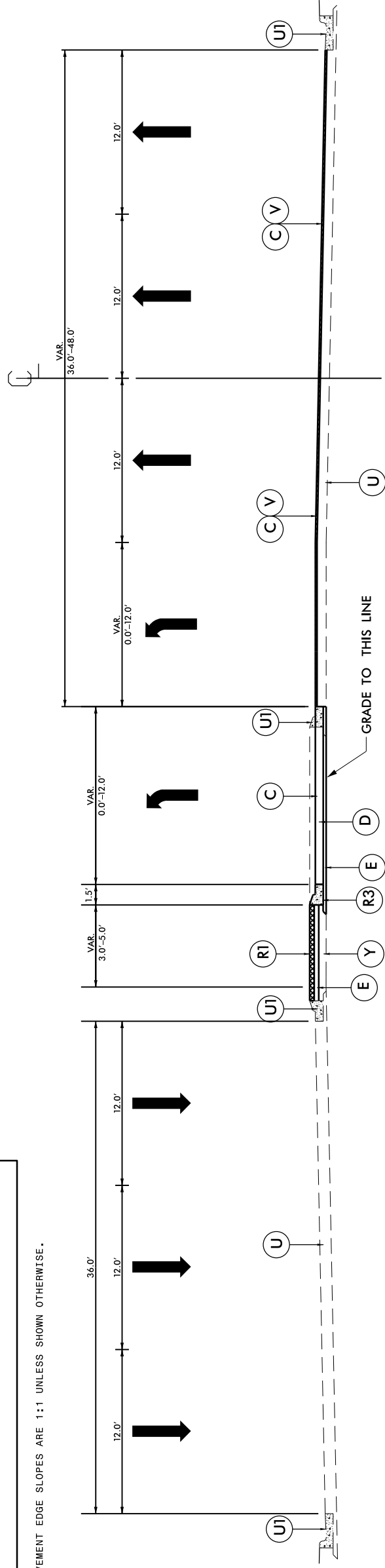

TYPICAL SECTION NO. 1

USE TYPICAL SECTION NO. 1

9+65.85 TO 15+80.33 -L-

PROJECT REFERENCE NO.	SS-4912AK	SHEET NO.	2-A
R/W SHEET NO.			
ROADWAY DESIGN ENGINEER		HYDRAULICS ENGINEER	

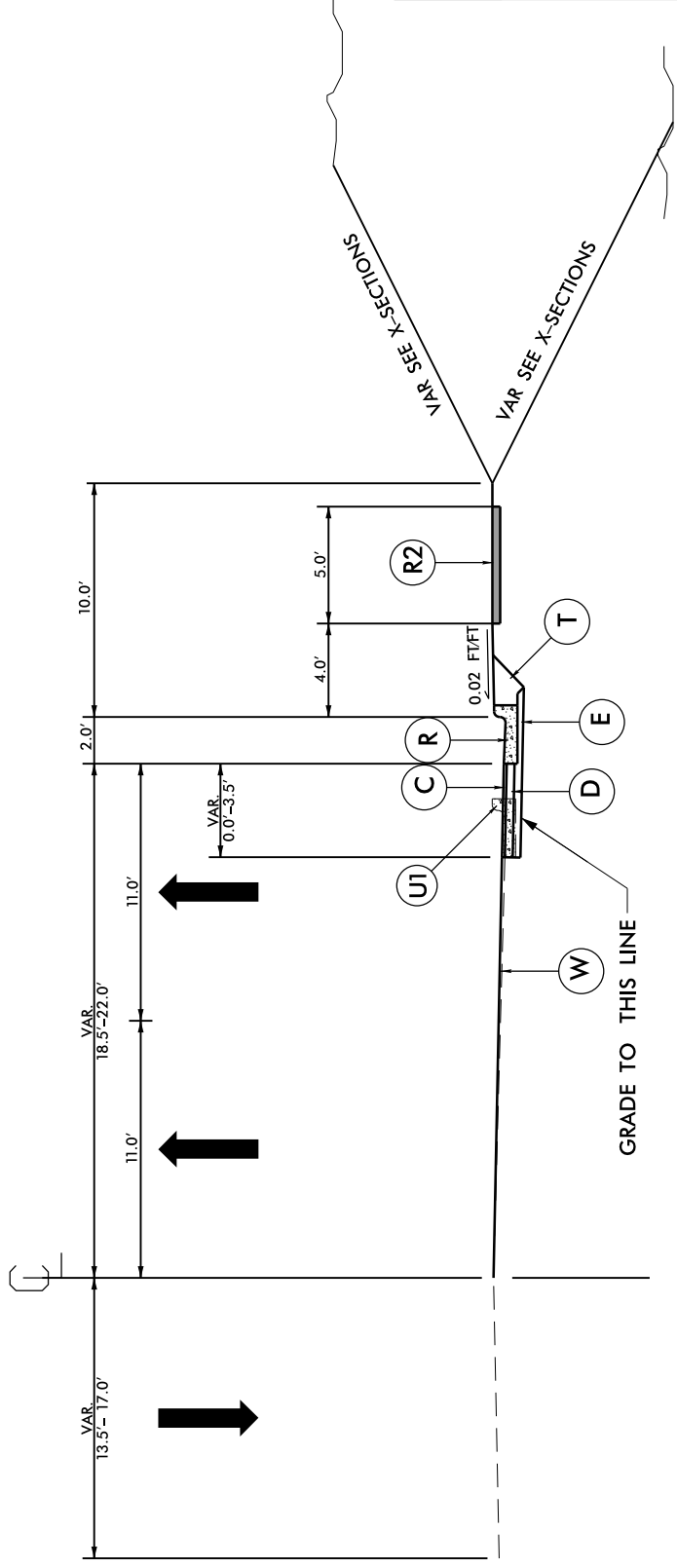

TYPICAL SECTION NO. 2

USE TYPICAL SECTION NO. 2

10+00.00 TO 12+69.84 -Y-

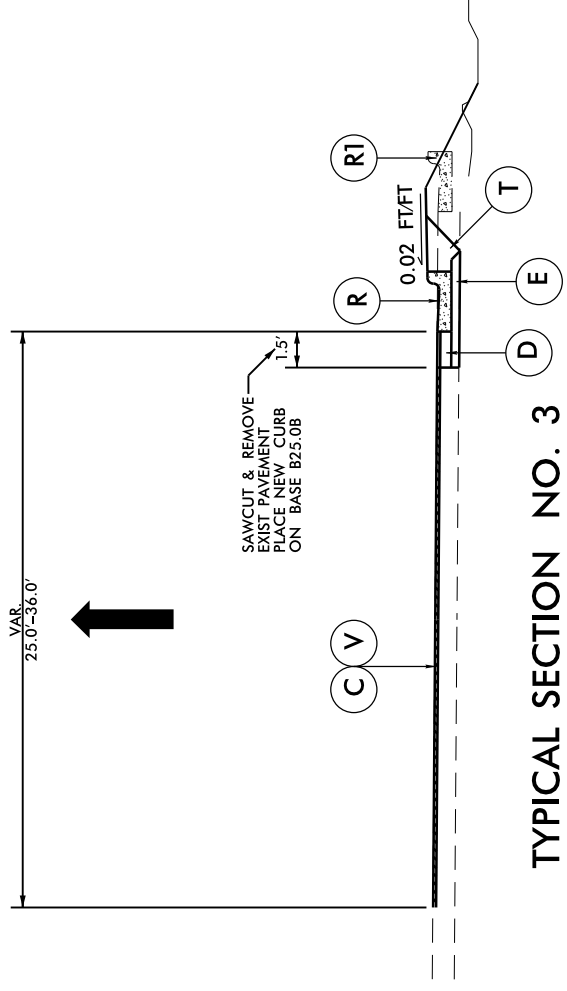

TYPICAL SECTION NO. 3

USE TYPICAL SECTION NO. 3

-RAMP- 10+00.00 TO 11+30.46

PAVEMENT SCHEDULE	
C	PROP. APPROX. 1.5" ASPHALT CONCRETE SURFACE COURSE, TYPE S9.5D, AT AN AVERAGE RATE OF 112 LBS. PER SQ. YD.
D	PROP. APPROX. 5.5" ASPHALT CONCRETE INTERMEDIATE COURSE, TYPE I19.0B, AT AN AVERAGE RATE OF 313.5 LBS. PER SQ. YD. FOR EACH OF 2 LIFTS
E	PROP. APPROX. 4" ASPHALT CONCRETE BASE COURSE, TYPE B25.0B, AT AN AVERAGE RATE OF 456 LBS. PER SQ. YD.
R	2'-6" CONCRETE CURB AND GUTTER
R1	4" CONCRETE ISLAND COVER
R2	4" CONCRETE SIDEWALK
T	EARTH MATERIAL.
U	EXISTING ASPHALT PAVEMENT.
U1	EXISTING CONCRETE CURB AND GUTTER.
V	MILLING BITUMINOUS PAVEMENT 1.5" DEPTH.
W	WEDGING

NOTE: PAVEMENT EDGE SLOPES ARE 1:1 UNLESS SHOWN OTHERWISE.

STATE OF NORTH CAROLINA
DIVISION OF HIGHWAYS

SUMMARY OF QUANTITIES

ITEM NUMBER	ITEM DESCRIPTION	UNIT	SECTION	QUANTITY
0000100000-N	MOBILIZATION	LS	800	1
0000400000-N	CONSTRUCTION SURVEYING	LS	801	1
0043000000-N	GRADING	LS	226	1
0050000000-E	SUPPLEMENTARY CLEARING & GRUBBING	ACR	226	1
1220000000-E	INCIDENTAL STONE BASE	TON	545	100
1297000000-E	MILLING ASPHALT PAVEMENT, 1.5" DEPTH	SY	607	3500
1330000000-E	INCIDENTAL MILLING	SY	607	150
1489000000-E	ASPHALT CONC BASE COURSE, TYPE B25.0B	TON	610	310
1498000000-E	ASPHALT CONC INTERMEDIATE COURSE, TYPE I19.0B	TON	610	260
1519000000-E	ASPHALT CONC SURFACE COURSE, TYPE S9.5B	TON	610	390
1575000000-E	ASPHALT BINDER FOR PLANT MIX	TON	620	50
1704000000-E	PATCHING EXISTING PAVEMENT	TON	SP	15
2542000000-E	1'-6" CONCRETE CURB & GUTTER	LF	846	560
2549000000-E	2'-6" CONCRETE CURB & GUTTER	LF	846	500
2591000000-E	4" CONCRETE SIDEWALK	SY	848	150
2605000000-N	CONCRETE CURB RAMP	EA	848	1
2627000000-E	4" CONCRETE ISLAND COVER	SY	852	155
4589000000-N	TRAFFIC CONTROL	LS	SP	1
4685000000-E	THERMOPLASTIC PAVEMENT MARKING LINES (4", 90 MILS)	LF	1205	140
4686000000-E	THERMOPLASTIC PAVEMENT MARKING LINES (4", 120 MILS)	LF	1205	1617
4710000000-E	THERMOPLASTIC PAVEMENT MARKING LINES (24", 120 MILS)	LF	1205	110
4725000000-E	THERMOPLASTIC PAVEMENT MARKING SYMBOL (90 MILS)	EA	1205	10
4810000000-E	PAINT PAVEMENT MARKING LINES (4")	LF	1205	3500
4835000000-E	PAINT PAVEMENT MARKING LINES (24")	LF	1205	110
4845000000-N	PAINT PAVEMENT MARKING SYMBOL	EA	1205	10
4905000000-N	SNOWPLOWABLE PAVEMENT MARKERS	EA	1253	25
5255000000-N	PORTABLE LIGHTING	LS	1413	1
6000000000-E	TEMPORARY SILT FENCE	LF	1605	400
6012000000-E	SEDIMENT CONTROL STONE	TON	1610	3
6042000000-E	1/4" HARDWARE CLOTH	LF	1632	25
6084000000-E	SEEDING & MULCHING	ACR	1660	0.5

COMPUTED BY: BKS
 CHECKED BY: REH

PROJECT NO.
SS-4912AK

SHEET NO.
3-A

RD248621

STATE OF NORTH CAROLINA DIVISION OF HIGHWAYS

SUMMARY OF EARTHWORK

SUMMARY OF EXISTING ASPHALT PAVEMENT REMOVAL

Station	Station	Uncl. Excav.	Embank. +%	Borrow	Waste
X- 10+00	12+75	.51		.15	.36
L- 10+00	15+80	.289		.0	.325
SUBTOTALS:		340			
SUBTOTALS:		340			
PROJECT TOTALS:		340			
PROJECT TOTALS:		340			
GRAND TOTALS:		340			
SAY:		400			

Note: Approximate quantities only. Unclassified excavation, Borrow excavation, Shoulder Borrow, Fine Grading, Clearing & Grubbing, Breaking of Existing Pavement and Removal of Existing Pavement will be paid for at the contract Lump Sum price for "Grading".

LINE	Station	Station	LOC LT/RT/CL	YD ²
RAMP	SEE PLANSHEET 4		RT	330
			TOTAL:	330
			SAY:	350

SUMMARY OF EXISTING CONCRETE PAVEMENT REMOVAL

LINE	Station	Station	LOC LT/RT/CL	YD ²
				587
INCLUDES QTY'S FOR REMOVAL OF EXISTING ISLAND, CURB & GUTTER AND SIDEWALK.				
			TOTAL:	587
			SAY:	600

PROJECT REFERENCE NO.	SS-4912AK
R/W SHEET NO.	4
ROADWAY DESIGN ENGINEER	HYDRAULICS ENGINEER

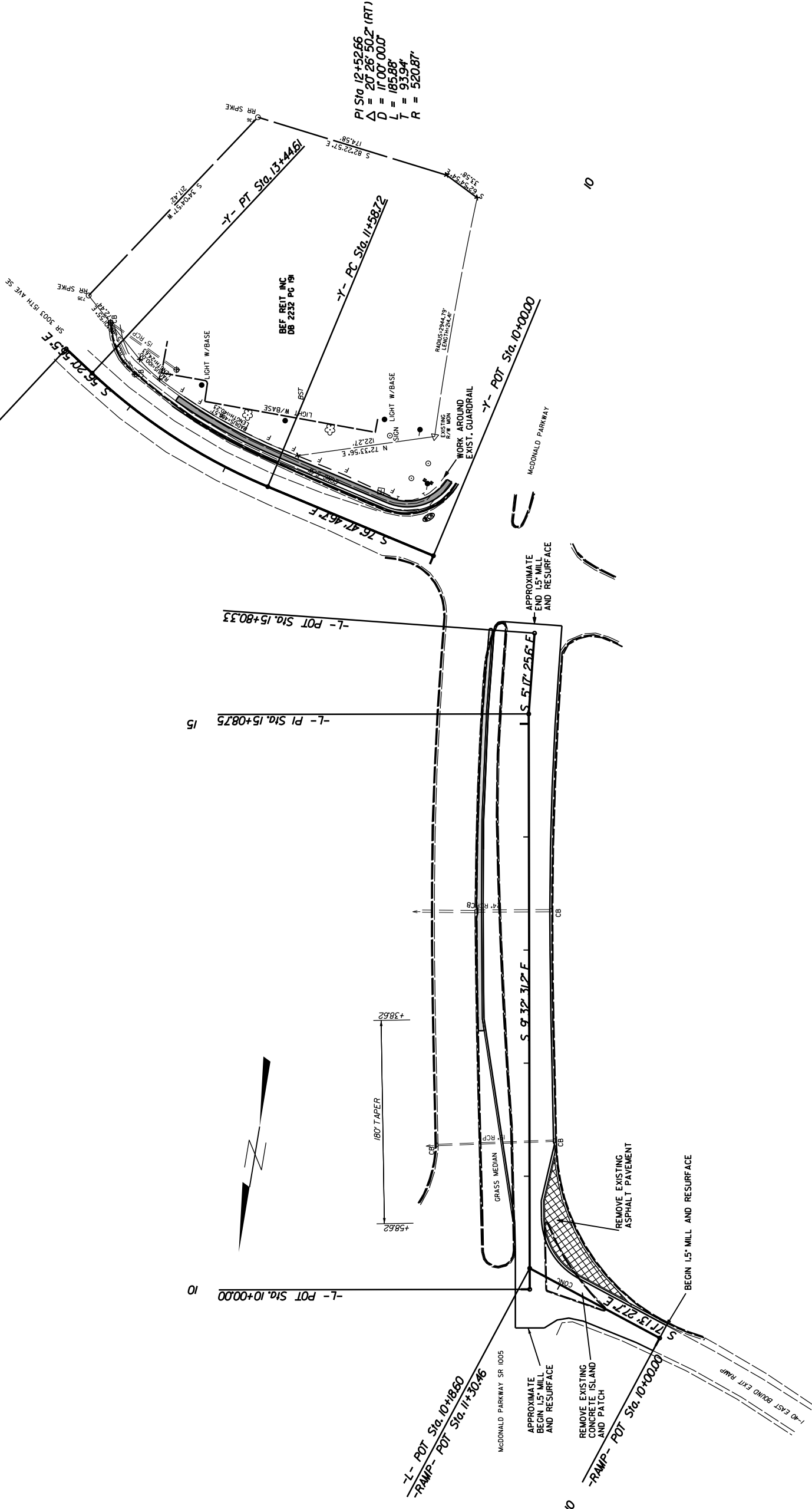
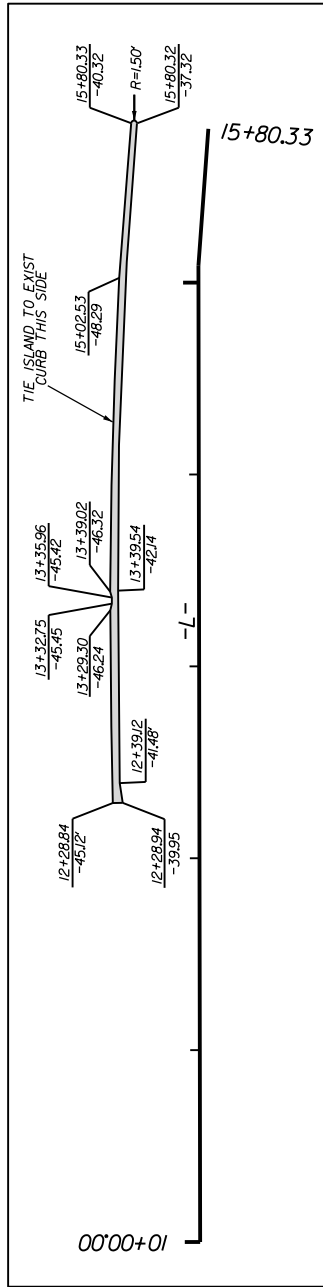

STATE OF NORTH CAROLINA
DIVISION OF HIGHWAYS

TRANSPORTATION MANAGEMENT PLAN

CATAWBA COUNTY

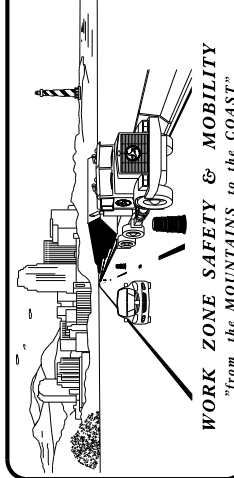
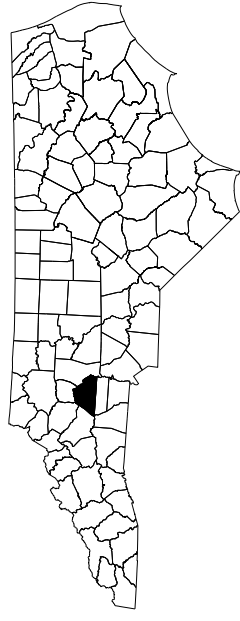

PROJECT:

SS-4912AK

SHEET NO.
TCP-1

INDEX OF SHEETS

SHEET NO.	TITLE
TCP-1	TITLE SHEET, AND INDEX OF SHEETS
TCP-1A	LIST OF APPLICABLE ROADWAY STANDARD DRAWINGS, LEGEND, AND TEMPORARY PAVEMENT MARKING
TCP-2	GENERAL NOTES
TCP-3	PHASE I OVERVIEW
TCP-4	PHASE II OVERVIEW
TCP-5	PHASE III OVERVIEW
TCP-6	PHASE IV OVERVIEW

APPROVED: _____
DATE: _____

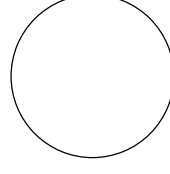

SEAL

ROADWAY STANDARD DRAWINGS

THE FOLLOWING ROADWAY STANDARDS AS SHOWN IN "ROADWAY STANDARD DRAWINGS" - PROJECT SERVICES UNIT - N.C. DEPARTMENT OF TRANSPORTATION - RALEIGH, N.C., DATED JANUARY 2012 ARE APPLICABLE TO THIS PROJECT AND BY REFERENCE HEREBY ARE CONSIDERED A PART OF THESE PLANS:

<u>STD. NO.</u>	<u>TITLE</u>
1101.01	WORK ZONE WARNING SIGNS
1101.02	TEMPORARY LANE CLOSURES
1101.04	TEMPORARY SHOULDER CLOSURES
1101.11	TRAFFIC CONTROL DESIGN TABLES
1110.01	STATIONARY WORK ZONE SIGNS
1110.02	PORTABLE WORK ZONE SIGNS
1115.01	FLASHING ARROW BOARDS
1130.01	DRUMS
1135.01	CONES
1145.01	BARRICADES
1150.01	FLAGGING DEVICES
1165.01	WORK VEHICLE LIGHTING SYSTEMS AND TMA DELINEATION
1180.01	SKINNY - DRUM
1205.01	PAVEMENT MARKINGS - LINE TYPES AND OFFSETS
1205.02	PAVEMENT MARKINGS - TWO LANE AND MULTILANE ROADWAYS
1205.03	PAVEMENT MARKINGS - EXITS AND ENTRANCE RAMP
1205.04	PAVEMENT MARKINGS - INTERSECTIONS
1205.05	PAVEMENT MARKINGS - TURN LANES
1205.06	PAVEMENT MARKINGS - LANE DROPS
1250.01	RAISED PAVEMENT MARKERS - INSTALLATION SPACING
1251.01	RAISED PAVEMENT MARKERS - (PERMANENT AND TEMPORARY)

LEGEND





GENERAL

- - - - EXIST. PVMT.
- NORTH ARROW
- PROPOSED PVMT.
-  WORK AREA

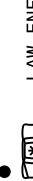

TEMPORARY PAVEMENT MARKING

- PAINT PAVEMENT MARKING LINES (4")
- PAINT PAVEMENT MARKING LINES (24")
- PAINT PAVEMENT MARKING SYMBOLS

TRAFFIC CONTROL DEVICES

-  DRUM
-  TEMPORARY CRASH CUSHION
-  FLASHING ARROW BOARD
-  LAW ENFORCEMENT
-  TRUCK MOUNTED ATTENUATOR (TMA)

TEMPORARY SIGNING

-  PORTABLE SIGN
-  STATIONARY SIGN
-  STATIONARY OR PORTABLE SIGN

- EXISTING LINES
- TEMPORARY LINES

PAVEMENT MARKING SYMBOLS

-  PAVEMENT MARKING SYMBOLS

APPROVED: _____ DATE: _____

SEAL



ROADWAY STANDARD
DRAWINGS & LEGEND

PROJECT NOTES

GENERAL NOTES

CHANGES MAY BE REQUIRED WHEN PHYSICAL DIMENSIONS IN THE DETAIL DRAWINGS, STANDARD DETAILS, AND ROADWAY DETAILS ARE NOT ATTAINABLE TO MEET FIELD CONDITIONS OR RESULT IN DUPLICATE OR UNDESIRABLE OVERLAPPING OF DEVICES. MODIFICATION MAY INCLUDE: MOVING, SUPPLEMENTING, COVERING, OR REMOVAL OF DEVICES AS DIRECTED BY THE ENGINEER.

THE FOLLOWING GENERAL NOTES APPLY AT ALL TIMES FOR THE DURATION OF THE CONSTRUCTION PROJECT EXCEPT WHEN OTHERWISE NOTED IN THE PLAN OR DIRECTED BY THE ENGINEER.

TIME RESTRICTIONS

A) DO NOT CLOSE OR NARROW TRAVEL LANES AS FOLLOWS:

ROAD NAME	DAY AND TIME RESTRICTIONS
SR 1005 (MCDONALD PARKWAY)	MONDAY THRU SUNDAY 6:00 AM TO 8:00 PM
SR 3003 (15TH AVE SE)	MONDAY THRU SUNDAY 6:00 AM TO 8:00 PM
I-40 EAST EXIT RAMP	MONDAY THRU SUNDAY 6:00 AM TO 8:00 PM

B) DO NOT CLOSE OR NARROW TRAVEL LANES DURING HOLIDAYS AND SPECIAL EVENTS AS FOLLOWS:

ROAD NAME

SR 1005 (MCDONALD PKWY)
SR 3003 (15th AVE SE)
I-40 EAST EXIT RAMP

HOLIDAY

- FOR ANY UNEXPECTED OCCURRENCE THAT CREATES UNUSUALLY HIGH TRAFFIC VOLUMES, AS DIRECTED BY THE ENGINEER.
- FOR NEW YEAR'S, BETWEEN THE HOURS OF 7:00 P.M. DECEMBER 31st TO 6:00 A.M. JANUARY 2ND. IF NEW YEAR'S DAY IS ON A FRIDAY, SATURDAY, SUNDAY, OR MONDAY THEN UNTIL 6:00 A.M. THE FOLLOWING TUESDAY.
- FOR EASTER, BETWEEN THE HOURS OF 6:00 A.M. THURSDAY AND 7:00 P.M. MONDAY.
- FOR MEMORIAL DAY, BETWEEN THE HOURS OF 6:00 A.M. FRIDAY TO 7:00 P.M. TUESDAY.
- FOR INDEPENDENCE DAY, BETWEEN THE HOURS OF 7:00 P.M. THE DAY BEFORE INDEPENDENCE DAY AND 6:00 A.M. THE DAY AFTER INDEPENDENCE DAY.
IF INDEPENDENCE DAY IS ON A FRIDAY, SATURDAY, SUNDAY OR MONDAY THEN BETWEEN THE HOURS OF 7:00 P.M. THE THURSDAY BEFORE INDEPENDENCE DAY AND 6:00 A.M. THE TUESDAY AFTER INDEPENDENCE DAY.
- FOR LABOR DAY, BETWEEN THE HOURS OF 7:00 P.M. FRIDAY AND 6:00 A.M. TUESDAY.
- FOR THANKSGIVING DAY, BETWEEN THE HOURS OF 6:00 P.M. TUESDAY TO 6:00 A.M. MONDAY.
- FOR CHRISTMAS, BETWEEN THE HOURS OF 7:00 P.M. THE FRIDAY BEFORE THE WEEK OF CHRISTMAS DAY AND 5:00 A.M. THE FOLLOWING TUESDAY AFTER THE WEEK OF CHRISTMAS.

LANE AND SHOULDER CLOSURE REQUIREMENTS

- REMOVE LANE CLOSURE DEVICES FROM THE LANE WHEN WORK IS NOT BEING PERFORMED BEHIND THE LANE CLOSURE OR WHEN A LANE CLOSURE IS NO LONGER NEEDED OR AS DIRECTED BY THE ENGINEER.
 - WHEN PERSONNEL AND/OR EQUIPMENT ARE WORKING WITHIN 15 FT OF AN OPEN TRAVEL LANE, CLOSE THE NEAREST OPEN SHOULDER USING ROADWAY STANDARD DRAWING NO. 1101.04 UNLESS THE WORK AREA IS PROTECTED BY BARRIER OR GUARDRAIL OR A LANE CLOSURE IS INSTALLED.
 - WHEN PERSONNEL AND/OR EQUIPMENT ARE WORKING ON THE SHOULDER ADJACENT TO AN UNDIVIDED FACILITY AND WITHIN 5 FT OF AN OPEN TRAVEL LANE, CLOSE THE NEAREST OPEN TRAVEL LANE USING ROADWAY STANDARD DRAWING NO. 1101.02 UNLESS THE WORK AREA IS PROTECTED BY BARRIER OR GUARDRAIL.
- WHEN PERSONNEL AND/OR EQUIPMENT ARE WORKING ON THE SHOULDER ADJACENT TO A DIVIDED FACILITY AND WITHIN 10 FT OF AN OPEN TRAVEL LANE, CLOSE THE NEAREST OPEN TRAVEL LANE USING ROADWAY STANDARD DRAWING NO. 1101.02 UNLESS THE WORK AREA IS PROTECTED BY BARRIER OR GUARDRAIL.

- WHEN PERSONNEL AND/OR EQUIPMENT ARE WORKING WITHIN A LANE OF TRAVEL OF AN UNDIVIDED OR DIVIDED FACILITY, CLOSE THE LANE ACCORDING TO THE TRAFFIC CONTROL PLANS, ROADWAY STANDARD DRAWINGS, OR AS DIRECTED BY THE ENGINEER. CONDUCT THE WORK SO THAT ALL PERSONNEL AND/OR EQUIPMENT REMAIN WITHIN THE CLOSED TRAVEL LANE.
- DO NOT WORK SIMULTANEOUSLY WITHIN 15 FT ON BOTH SIDES OF AN OPEN TRAVELWAY, RAMP, OR LOOP WITHIN THE SAME LOCATION UNLESS PROTECTED WITH GUARDRAIL OR BARRIER.
- DO NOT INSTALL MORE THAN ONE LANE CLOSURE IN ANY ONE DIRECTION ON SR 1005.

TRAFFIC PATTERN ALTERATIONS

- NOTIFY THE ENGINEER TWENTY ONE (21) CALENDAR DAYS PRIOR TO ANY TRAFFIC PATTERN ALTERATION.

SIGNING

- INSTALL ADVANCE WORK ZONE WARNING SIGNS WHEN WORK IS WITHIN 40 FT FROM THE EDGE OF TRAVEL LANE AND NO MORE THAN THREE (3) DAYS PRIOR TO THE BEGINNING OF CONSTRUCTION.
 - ENSURE ALL NECESSARY SIGNING IS IN PLACE PRIOR TO ALTERING ANY TRAFFIC PATTERN.
- TRAFFIC CONTROL DEVICES
- WHEN LANE CLOSURES ARE NOT IN EFFECT SPACE CHANNELIZING DEVICES IN WORK AREAS NO GREATER IN FEET THAN TWICE THE POSTED SPEED LIMIT (MPH) EXCEPT, 10 FT ON-CENTER IN RADIUS, AND 3 FT OFF THE EDGE OF AN OPEN TRAVELWAY. REFER TO STANDARD SPECIFICATIONS FOR ROADS AND STRUCTURES SECTIONS 1130 (DRUMS), 1135 (CONES) AND 1180 (SKINNY DRUMS) FOR ADDITIONAL REQUIREMENTS.

PHASE I

PROJ. REFERENCE NO.	SHEET NO.
SS-4912AK	TCP-3

SR 1005 - McDONALD PARKWAY
 SR 3003 - 15th AVENUE SE

NOTE: THE CONTRACTOR WILL NOT BE ALLOWED TO CLOSE OR NARROW A LANE OF TRAFFIC ON SR 1005, SR 3003 OR I-40 EAST EXIT RAMP DURING DAYTIME HOURS.

MONDAY THRU SUNDAY 6:00 A.M. THRU 8:00 P.M

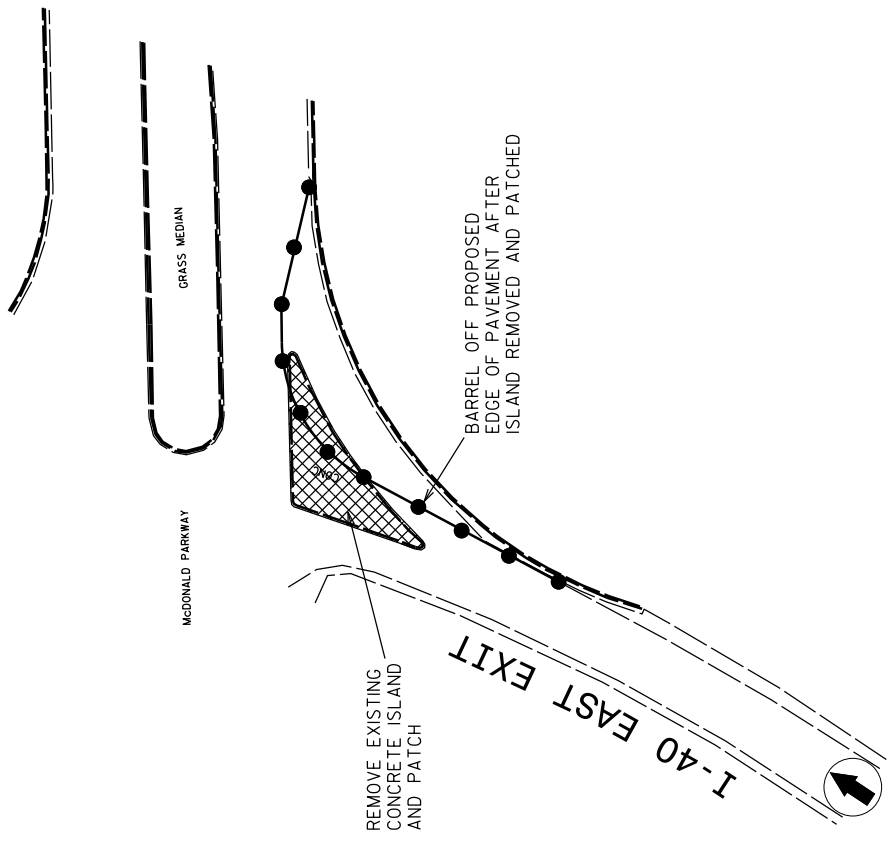

PHASE I

STEP 1: CONTRACTOR SHALL PLACE ADVANCED WORK ZONE WARNING SIGNS ALONG SR 1005, SR 3003 AND I-40 ENTRANCE AND EXIT RAMP (STD. 1101.01 SHEET 2 OF 3).

STEP 2: USING PLANSHEETS 4 AND TCP-3, AND ADHERING TO DAY AND TIME RESTRICTIONS IN THE CONTRACT AND THE TRAFFIC CONTROL PLAN GENERAL NOTES AND PHASING (TCP-2 & TCP 3) THE CONTRACTOR SHALL REMOVE THE EXISTING CONCRETE ISLAND ON RAMP AND PATCH AREA UP TO THE LEVEL OF THE EXISTING PAVEMENT.

STEP 3: USING PLANSHEETS 2A, 4 AND TCP-3 THE CONTRACTOR SHALL BARREL OFF EXISTING PAVEMENT AT THE LOCATION OF THE PROPOSED EDGE OF PAVEMENT.

STEP 4: COORDINATE WITH NCDOT TRAFFIC SERVICES UNIT TO INSTALL PROPOSED SIGNAL AND INITIATE ITS OPERATION.

SAM NICHOLS - DIVISION 12 TRAFFIC ENGINEER
 1710 East Marion Street
 Shelby, NC 28152
 704-480-9033 OR 704-480-9020

LEGEND

▨	PROPOSED CONSTRUCTION
•	DRUM

NOTE: SIGNAL WORK TO BE PERFORMED BY NCDOT FORCES. NOTIFY NCDOT TRAFFIC SERVICES ONE (1) WEEK PRIOR TO BEGINNING WORK TO COORDINATE SIGNAL ADJUSTMENTS.

APPROVED: _____ DATE: _____

SEAL



PHASE I OVERVIEW

PHASE II

PROJ. REFERENCE NO. SS-4912AK
SHEET NO. TCP-4

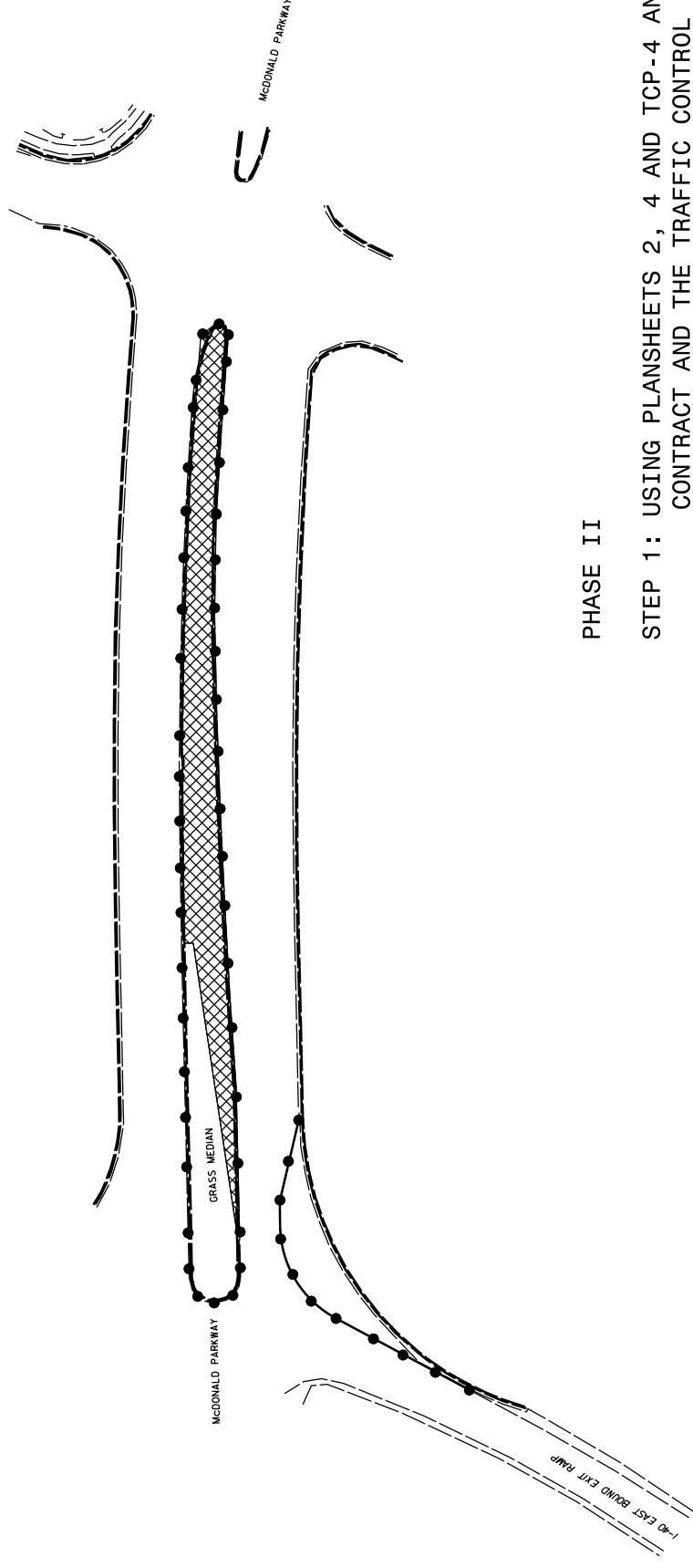

PHASE II

- STEP 1:** USING PLANSHEETS 2, 4 AND TCP-4 AND ADHERING TO DAY AND TIME RESTRICTIONS IN THE CONTRACT AND THE TRAFFIC CONTROL PLAN GENERAL NOTES AND PHASING. THE CONTRACTOR EXCAVATE EARTHEN MATERIAL FROM EXISTING MEDIAN TO THE LEVEL OF THE PROPOSED SUBGRADE AND PREPARE SUBGRADE FOR PROPOSED PAVEMENT PER THE STANDARD SPECIFICATIONS.
- STEP 2:** THE CONTRACTOR SHALL PLACE PAVEMENT LAYERS IN EXISTING MEDIAN AS SHOWN ON PLANS TO THE WITHIN 1 1/2" OF THE SURROUNDING EXISTING PAVEMENT.
- STEP 3:** THE CONTRACTOR SHALL PLACE PROPOSED 1'-6" CONCRETE CURB AND GUTTER AND CONCRETE ISLAND COVERS AS SHOWN ON PLANSHEETS 2, 4 AND TCP-4.

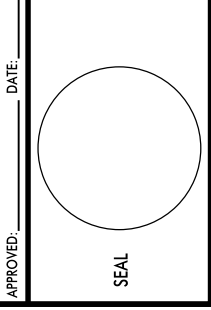
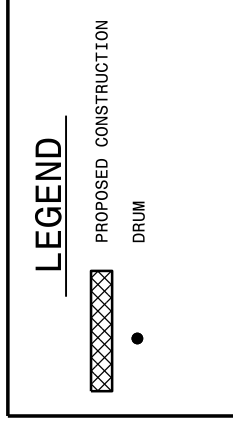

APPROVED: _____ DATE: _____



PHASE II OVERVIEW

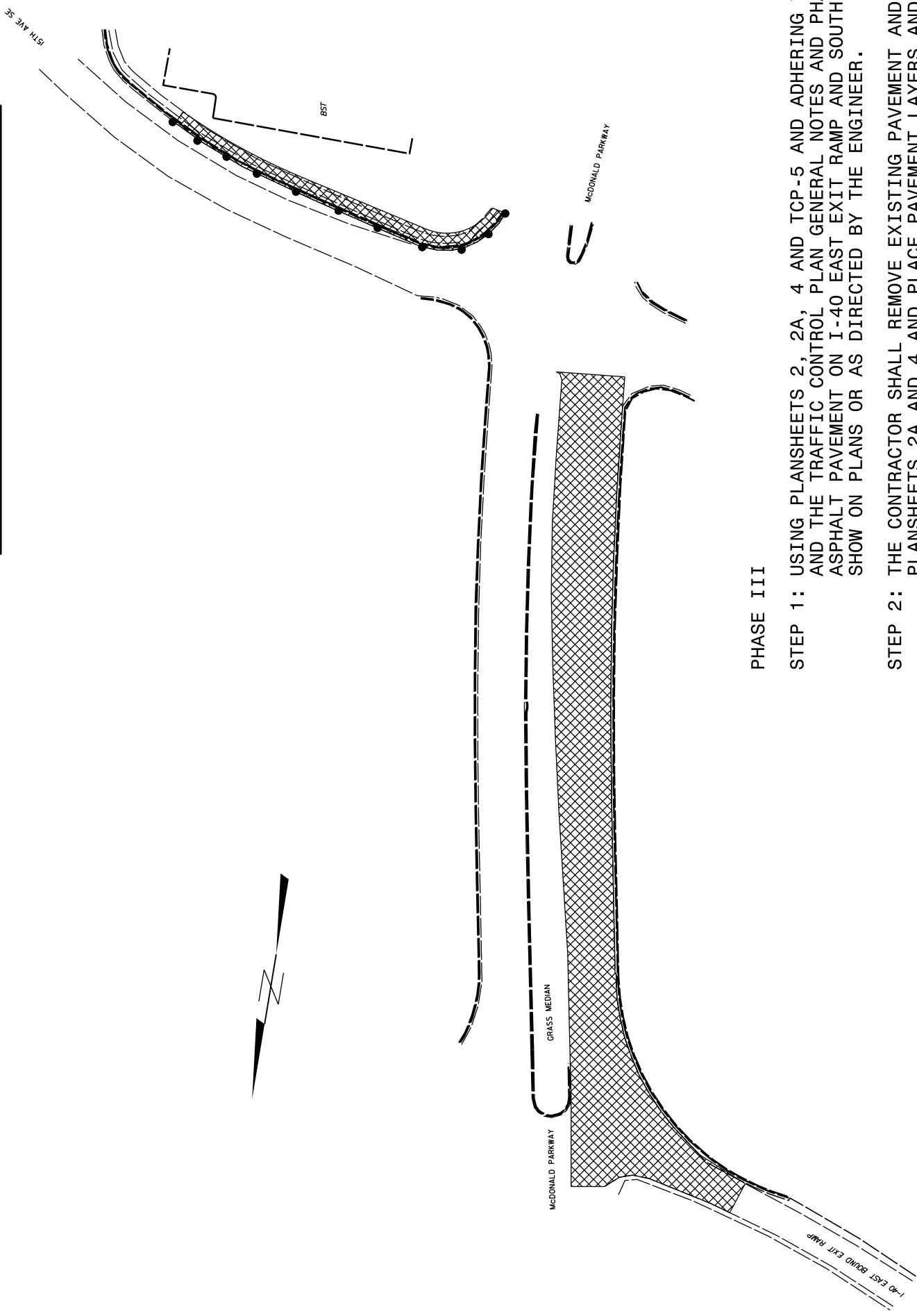

PHASE III



PHASE III

- STEP 1: USING PLANSHEETS 2, 2A, 4 AND TCP-5 AND ADHERING TO DAY AND TIME RESTRICTIONS IN THE CONTRACT AND THE TRAFFIC CONTROL PLAN GENERAL NOTES AND PHASING. THE CONTRACTOR SHALL MILL EXISTING ASPHALT PAVEMENT ON I-40 EAST EXIT RAMP AND SOUTH BOUND SR 1005 (MCDONALD PARKWAY) TO LIMITS SHOWN ON PLANS OR AS DIRECTED BY THE ENGINEER.
- STEP 2: THE CONTRACTOR SHALL REMOVE EXISTING PAVEMENT AND CURB AND GUTTER AS SHOWN ON PLANSHEETS 2A AND 4 AND PLACE PAVEMENT LAYERS AND CURB AND GUTTER TO LEVEL SHOWN ON PLANS EXCLUDING FINAL SURFACE LAYER ON I-40 EAST EXIT RAMP AND SR 1005.
- STEP 3: USING PLANSHEETS 2A, 4 AND STD. 1101.02 SHEET 1 OF 15, REMOVE EXISTING SIDEWALK AND CURB AND GUTTER ON SR 3003 AS SHOWN ON THE PLANS.
- STEP 4: PLACE PAVEMENT LAYERS AND CURB AND GUTTER AS SHOWN ON THE PLANS ON RAMP AND SR 3003.
- STEP 5: PLACE SIDEWALK AS SHOWN ON PLANS.

LEGEND

-  PROPOSED CONSTRUCTION
-  DRUM

APPROVED: _____ DATE: _____

SEAL

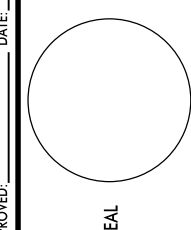

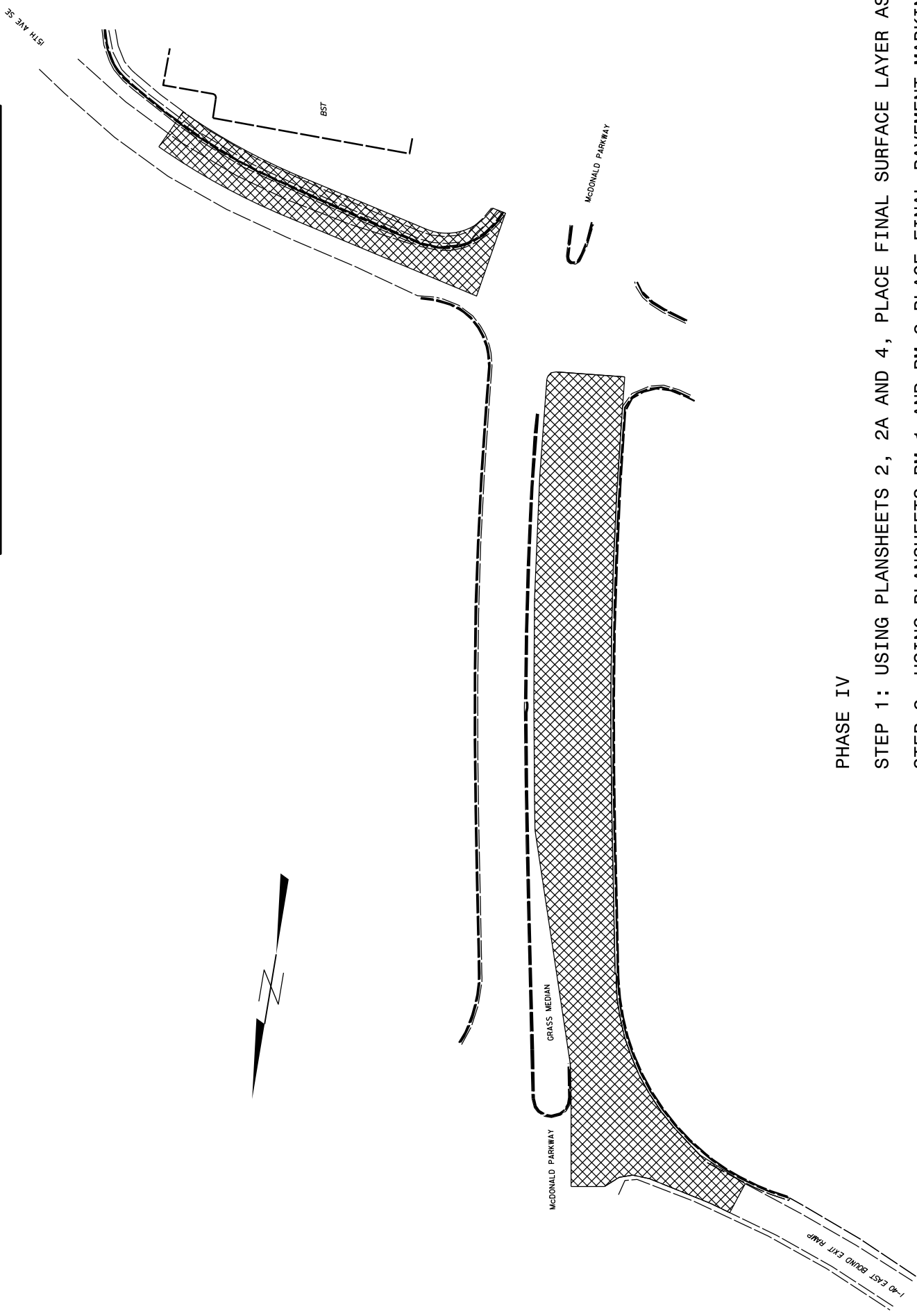

PHASE IV



PHASE IV

- STEP 1: USING PLANSHEETS 2, 2A AND 4, PLACE FINAL SURFACE LAYER AS HOWN ON PLANS.
- STEP 2: USING PLANSHEETS PM-1 AND PM-2 PLACE FINAL PAVEMENT MARKINGS AND MARKERS AS SHOWN ON PLANS.
- STEP 3: UPON COMPLETION OF ALL CONSTRUCTION OPERATIONS AND FINAL ACCEPTANCE OF PROJECT THE CONTRACTOR SHALL REMOVE ALL TRAFFIC CONTROL DEVICES FROM THE PROJECT.

LEGEND

-  PROPOSED CONSTRUCTION
-  DRUM

APPROVED: _____ DATE: _____

SEAL

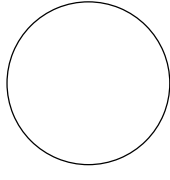
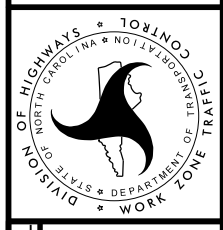
PHASE IV OVERVIEW

FINAL PAV'T MARKING SCHEDULE

TIP Project # SS-4912AK

SYMBOL	DESCRIPTI	FINAL PAVEMENT MARKINGS
T2	WHITE STOPBAR	THERMOPLASTIC(24", 120 MILS)
T8	2 FT. - 6 FT./SP WHITE MINISKIP	THERMOPLASTIC(4", 120 MILS)
TC	10 FT. WHITE SKIP	
TD	3 FT. - 9 FT./SP WHITE MINISKIP	
TE	WHITE SOLID LANE LINE	
TI	YELLOW DOUBLE CENTER	
TB	YELLOW EDGELINE	THERMOPLASTIC(4", 90 MILS)
UA	LEFT TURN ARROW	THERMOPLASTICPAVEMENT MARKING SYMBOLS (90 MILS)
UB	RIGHT TURN ARROW	

SEE ROADWAY STANDARD DRAWING NUMBERS 1205.01, 1205.02, 1205.04, 1205.05, 1205.06, 1205.08, 1205.09, 1250.01 AND 1253.01

APPROVED: _____ DATE: _____

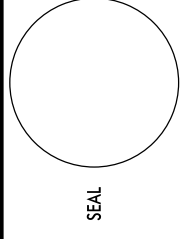

FINAL PAVEMENT MARKING PLAN

SCALE: NONE
DATE: 06-11
DWG. BY: BKS
DESIGN BY:
REVIEWED BY:

NO.	REVISIONS



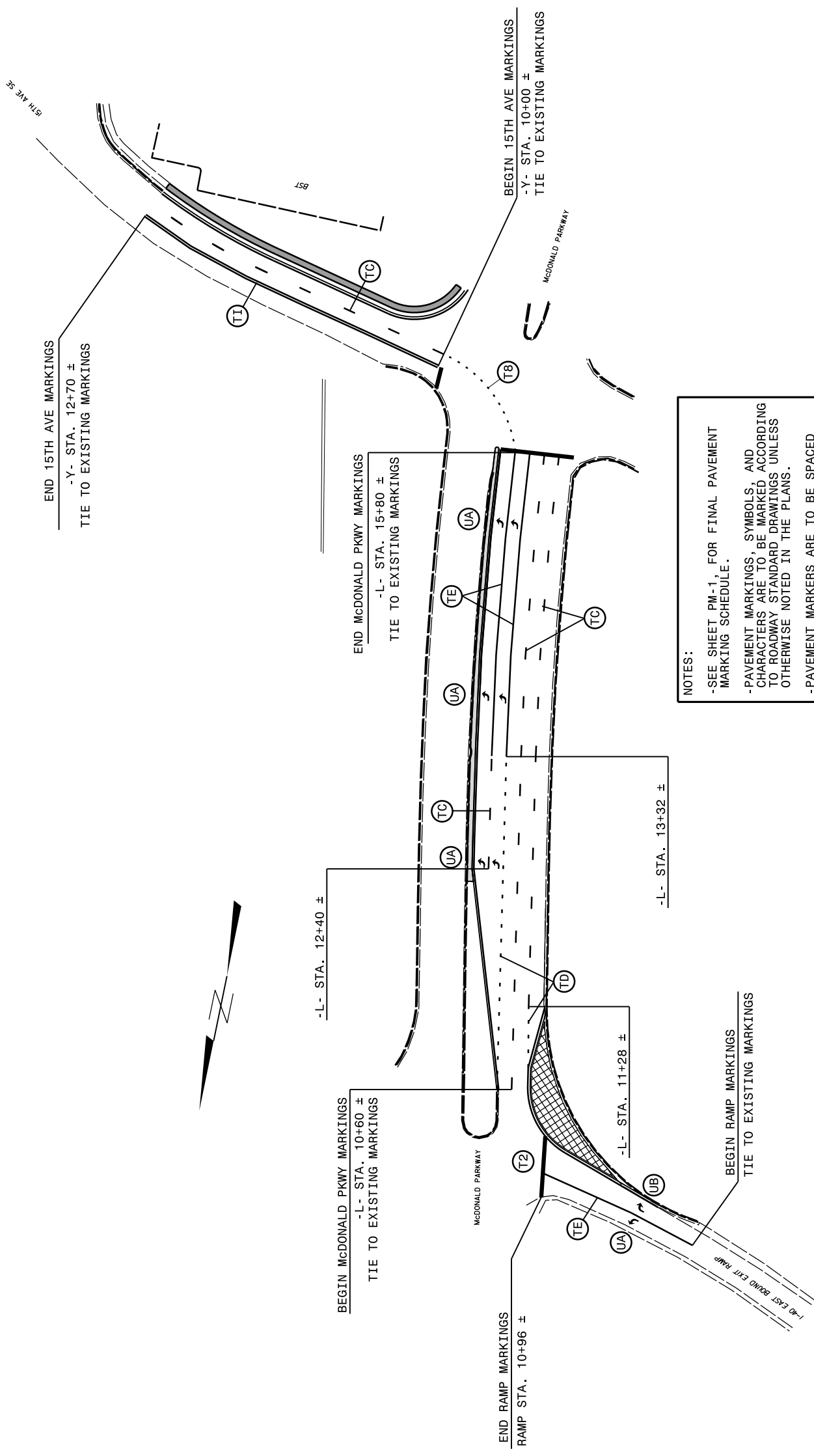

NOTES:
 -SEE SHEET PM-1, FOR FINAL PAVEMENT MARKING SCHEDULE.
 -PAVEMENT MARKINGS, SYMBOLS, AND CHARACTERS ARE TO BE MARKED ACCORDING TO ROADWAY STANDARD DRAWINGS UNLESS OTHERWISE NOTED IN THE PLANS.
 -PAVEMENT MARKERS ARE TO BE SPACED ACCORDING TO THE ROADWAY STANDARD DRAWINGS.

APPROVED: _____ DATE: _____

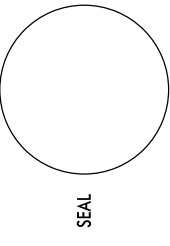

REVISIONS	
NO.	DATE

SCALE: NONE
 DATE: 06-11
 DWG. BY: BKS
 DESIGN BY:
 REVIEWED BY:

FINAL PAVEMENT MARKING PLAN

PROJECT: SS-4912AK

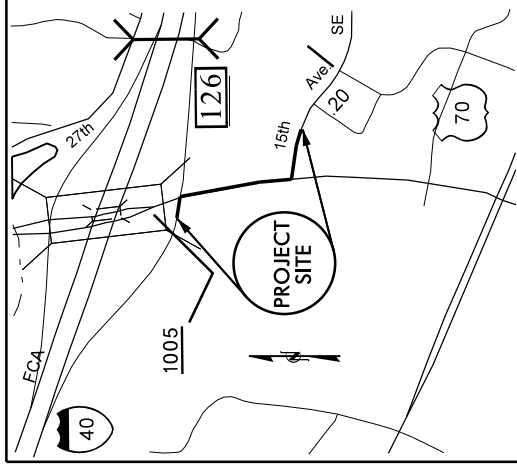

VICINITY MAP: NOT TO SCALE

STATE OF NORTH CAROLINA DIVISION OF HIGHWAYS PLAN FOR PROPOSED HIGHWAY EROSION CONTROL

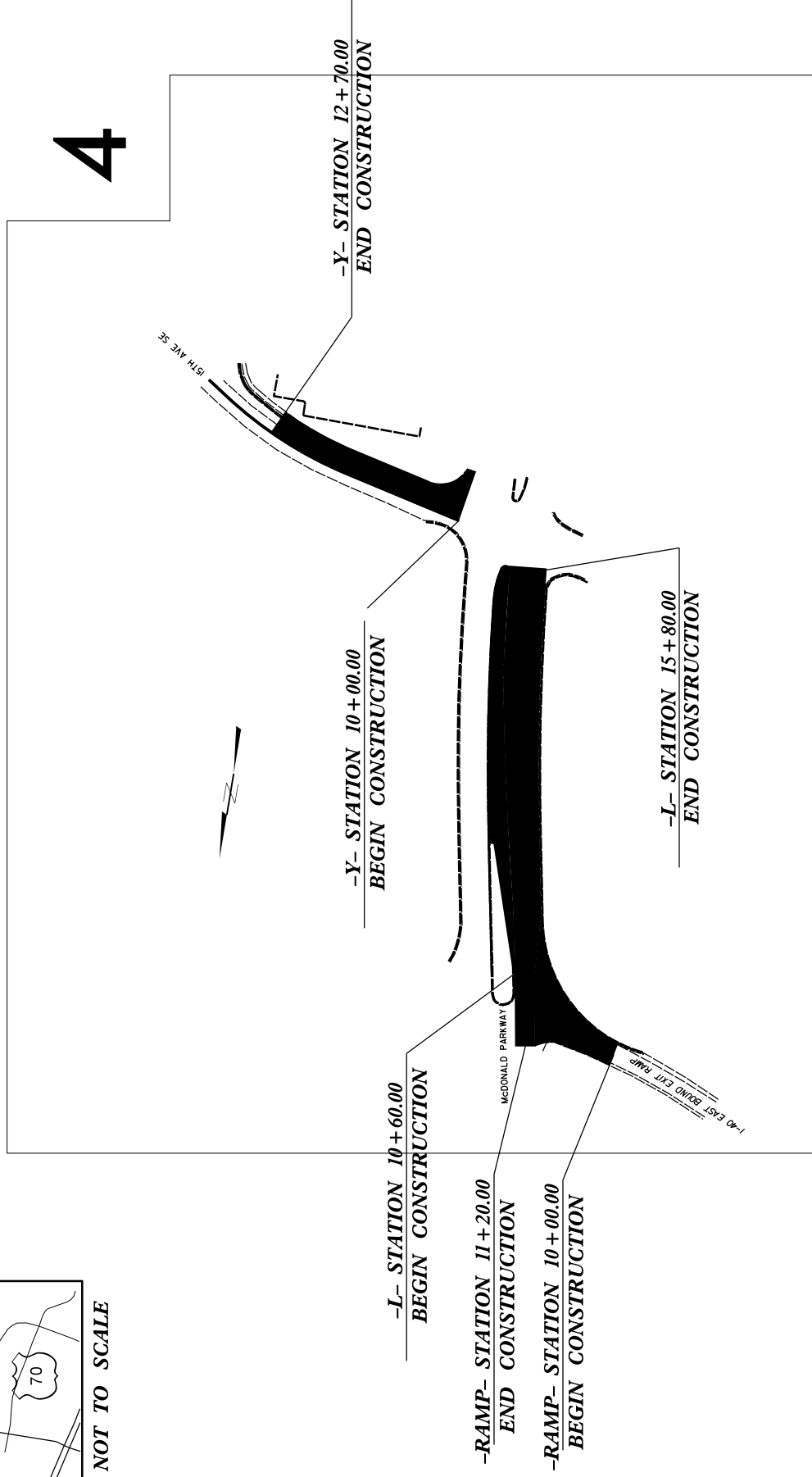

STATE	STATE PROJECT REFERENCE NO.	SHEET NO.	TOTAL SHEETS
N.C.	SS-4912AK	EC-1	
STATE PROJECT	F.A. PROJECT	DESCRIPTION	

EROSION AND SEDIMENT CONTROL MEASURES

Std. #	Description	Symbol
1630.03	Temporary Silt Ditch	---
1630.05	Temporary Diversion	---
1605.01	Temporary Silt Fence	---
1606.01	Special Sediment Control Fence	---
1622.01	Temporary Berms and Slope Drains	---
1630.02	Silt Basin Type B	---
1633.01	Temporary Rock Silt Check Type-A	---
	Temporary Rock Silt Check Type-A with Matting and Polyacrylamide (PAM)	---
1633.02	Temporary Rock Silt Check Type-B	---
	Wattle/Coir Fiber Wattle	---
	Wattle/Coir Fiber Wattle with Polyacrylamide (PAM)	---
1634.01	Temporary Rock Sediment Dam Type-A	---
1634.02	Temporary Rock Sediment Dam Type-B	---
1635.01	Rock Pipe Inlet Sediment Trap Type-A	---
1635.02	Rock Pipe Inlet Sediment Trap Type-B	---
1630.04	Stilling Basin	---
1630.06	Special Stilling Basin	---
	Rock Inlet Sediment Trap Type A	A
1632.01	Type B	B
1632.02	Type C	C
1632.03	Skimmer Basin	---
	Tiered Skimmer Basin	---
	Infiltration Basin	---

GRAPHIC SCALE

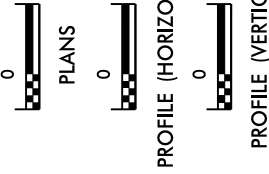

ROADSIDE ENVIRONMENTAL UNIT
DIVISION OF HIGHWAYS
STATE OF NORTH CAROLINA

THESE EROSION AND SEDIMENT CONTROL PLANS COMPLY WITH THE REGULATIONS SET FORTH BY THE NCG-010000 GENERAL CONSTRUCTION PERMIT EFFECTIVE AUGUST 3, 2011 ISSUED BY THE NORTH CAROLINA DEPARTMENT OF ENVIRONMENT AND NATURAL RESOURCES DIVISION OF WATER QUALITY.

Prepared in the Office of:
DIVISION 12 DDC UNIT
1710 East Marion St.
Shelby, NC 28152
2012 STANDARD SPECIFICATIONS

Roadway Standard Drawings

The following roadway english standards as appear in "Roadway Standard Drawings", - Roadway Design Unit - N. C. Department of Transportation - Raleigh, N. C., dated January 2012 and the latest revision thereto are applicable to this project and by reference hereby are considered a part of these plans.

1605.01 Temporary Silt Fence
1606.01 Special Sediment Control Fence

REINFORCED TEMPORARY SILT FENCE DETAIL

PROJECT REFERENCE NO. SS-492AK	SHEET NO. EC-2
RAW SHEET NO. ROADWAY DESIGN ENGINEER	HYDRAULICS ENGINEER

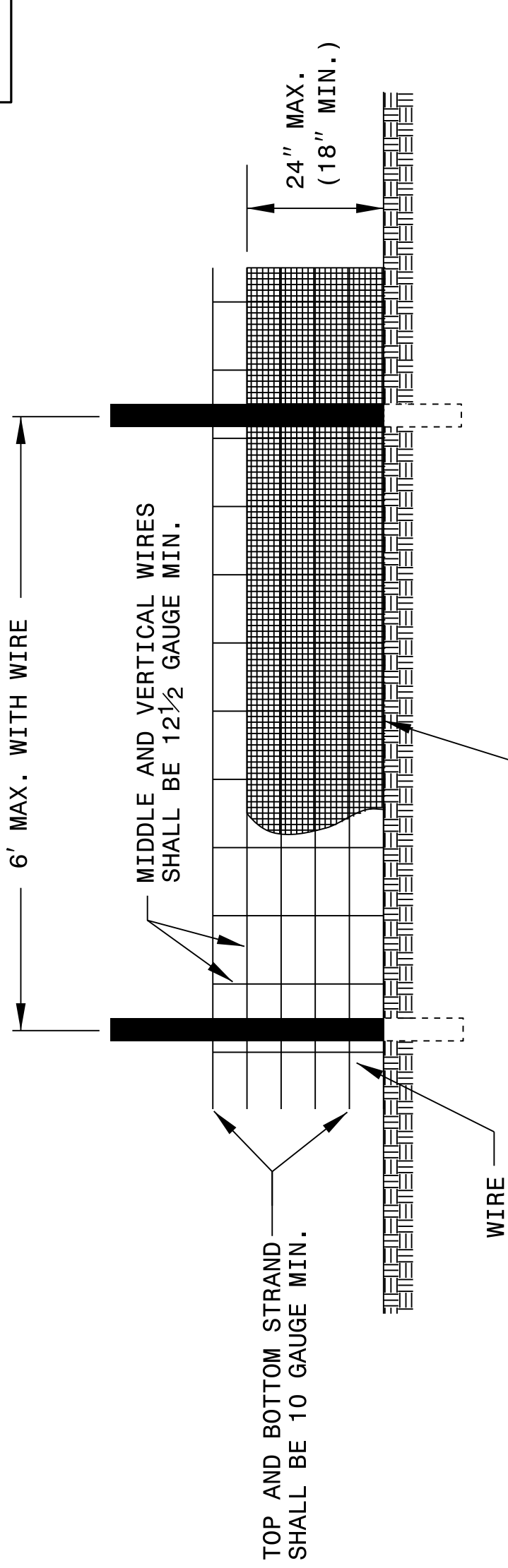

NOTES

- USE FILTRATION GEOTEXTILE A MINIMUM OF 36" IN WIDTH AND FASTEN ADEQUATELY TO THE POSTS AND WIRE AS DIRECTED.
- USE WIRE A MINIMUM OF 32" IN WIDTH AND WITH A MINIMUM OF 6 LINE WIRES WITH 12" STAY SPACING.
- PROVIDE 5'-0" STEEL POST OF THE SELF-FASTENER ANGLE STEEL TYPE.
- FOR MECHANICAL SLICING METHOD INSTALLATION, GEOTEXTILE SHALL BE A MAXIMUM OF 18" ABOVE GROUND SURFACE.

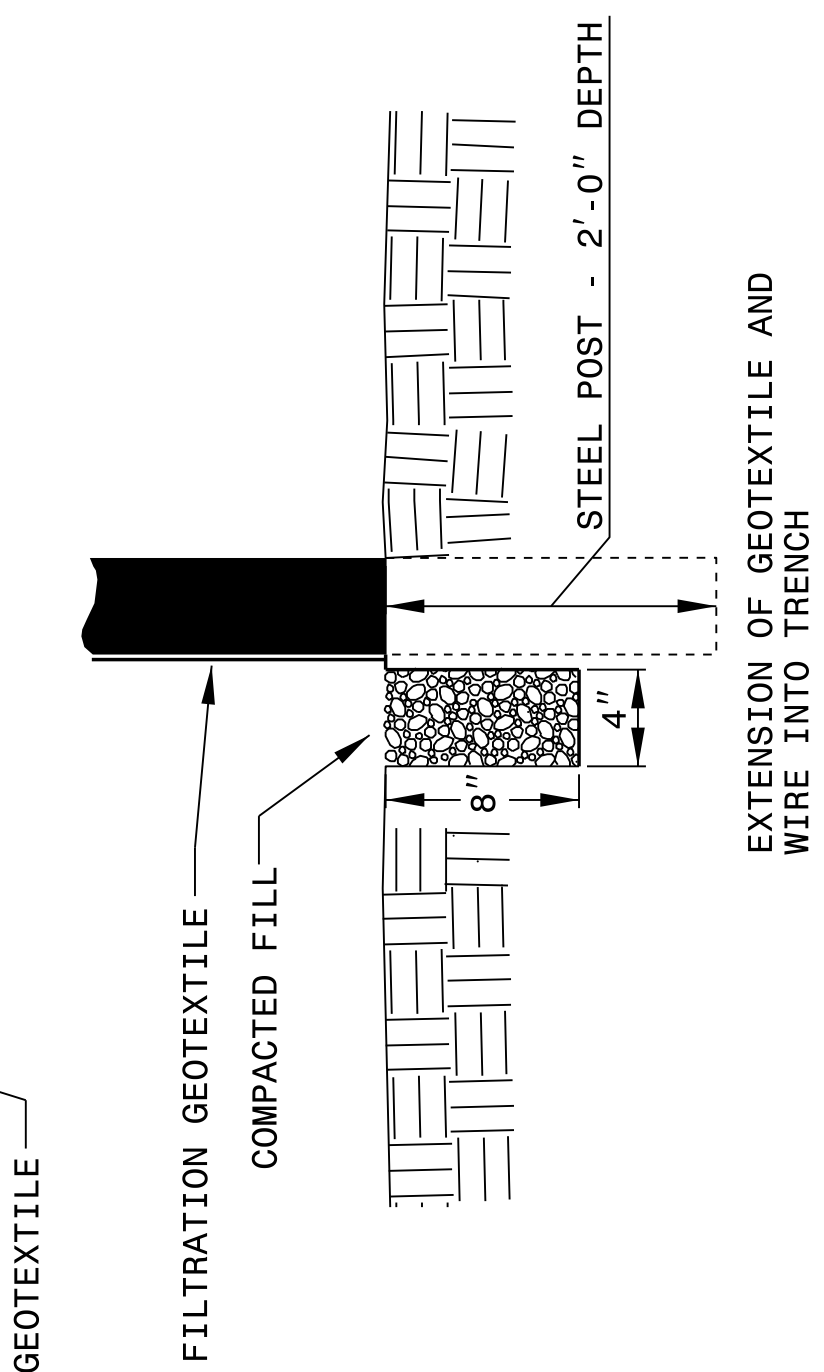

DIVISION OF HIGHWAYS
STATE OF NORTH CAROLINA

SOIL STABILIZATION TIMEFRAMES

PROJECT REFERENCE NO. SS-4912AK	SHEET NO. EC-3
ROADWAY DESIGN ENGINEER	HYDRAULICS ENGINEER

<i>SITE DESCRIPTION</i>	<i>STABILIZATION TIME</i>	<i>TIMEFRAME EXCEPTIONS</i>
PERIMETER DIKES, SWALES, DITCHES AND SLOPES	7 DAYS	NONE
HIGH QUALITY WATER (HOW) ZONES	7 DAYS	NONE
SLOPES STEEPER THAN 3:1	7 DAYS	IF SLOPES ARE 10' OR LESS IN LENGTH AND ARE NOT STEEPER THAN 2:1, 14 DAYS ARE ALLOWED.
SLOPES 3:1 OR FLATTER	14 DAYS	7 DAYS FOR SLOPES GREATER THAN 50' IN LENGTH.
ALL OTHER AREAS WITH SLOPES FLATTER THAN 4:1	14 DAYS	NONE, EXCEPT FOR PERIMETERS AND HOW ZONES.

NOTE: PLACE 3' SECTIONS OF SPECIAL
 SEDIMENT CONTROL FENCE AT LOW POINTS IN
 SILT FENCE OR AS DIRECTED BY ENGINEER

PROJECT REFERENCE NO. SS-4912AK	SHEET NO. EC-4/CONST-4
RAW SHEET NO. ROADWAY DESIGN ENGINEER	HYDRAULICS ENGINEER

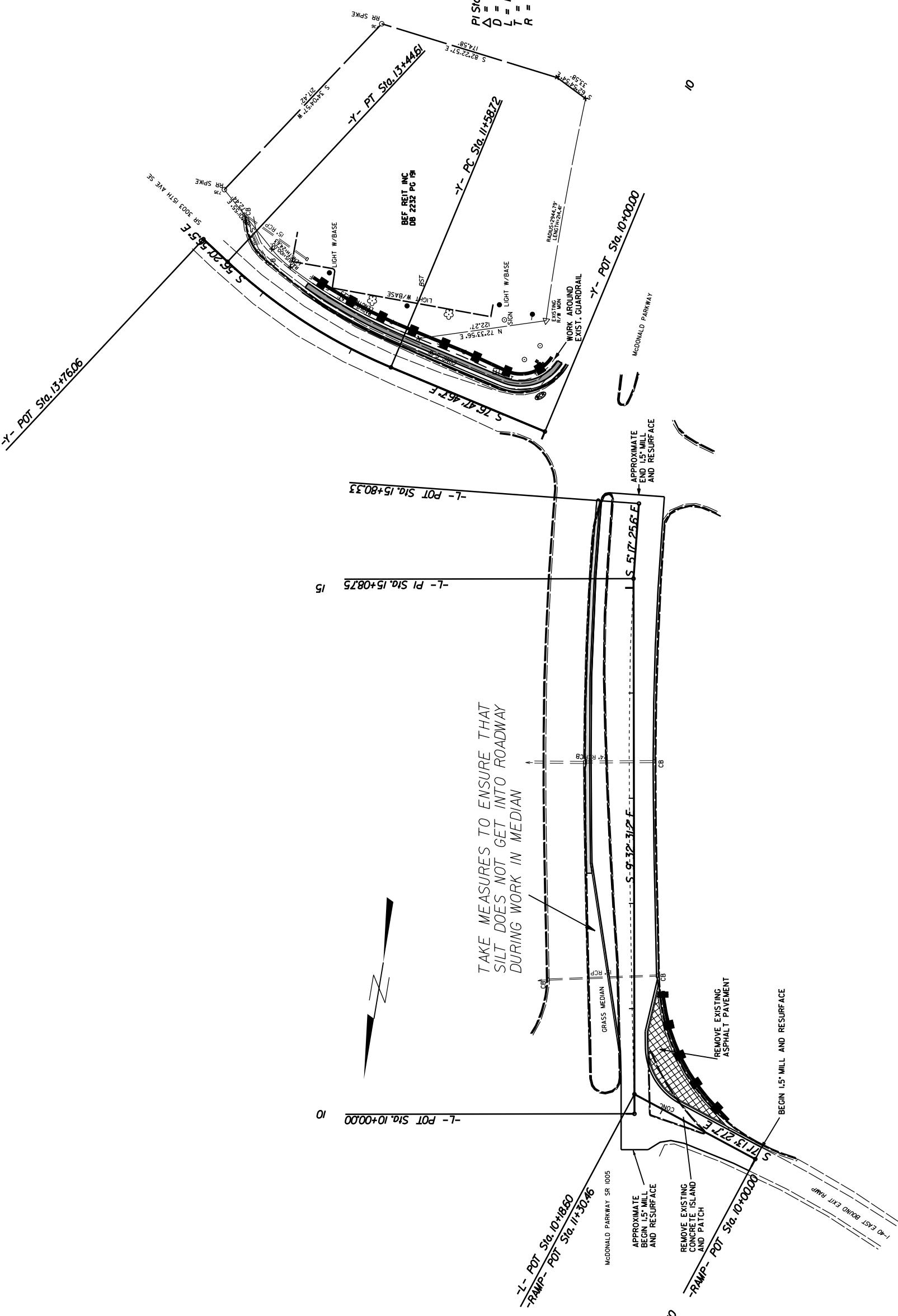

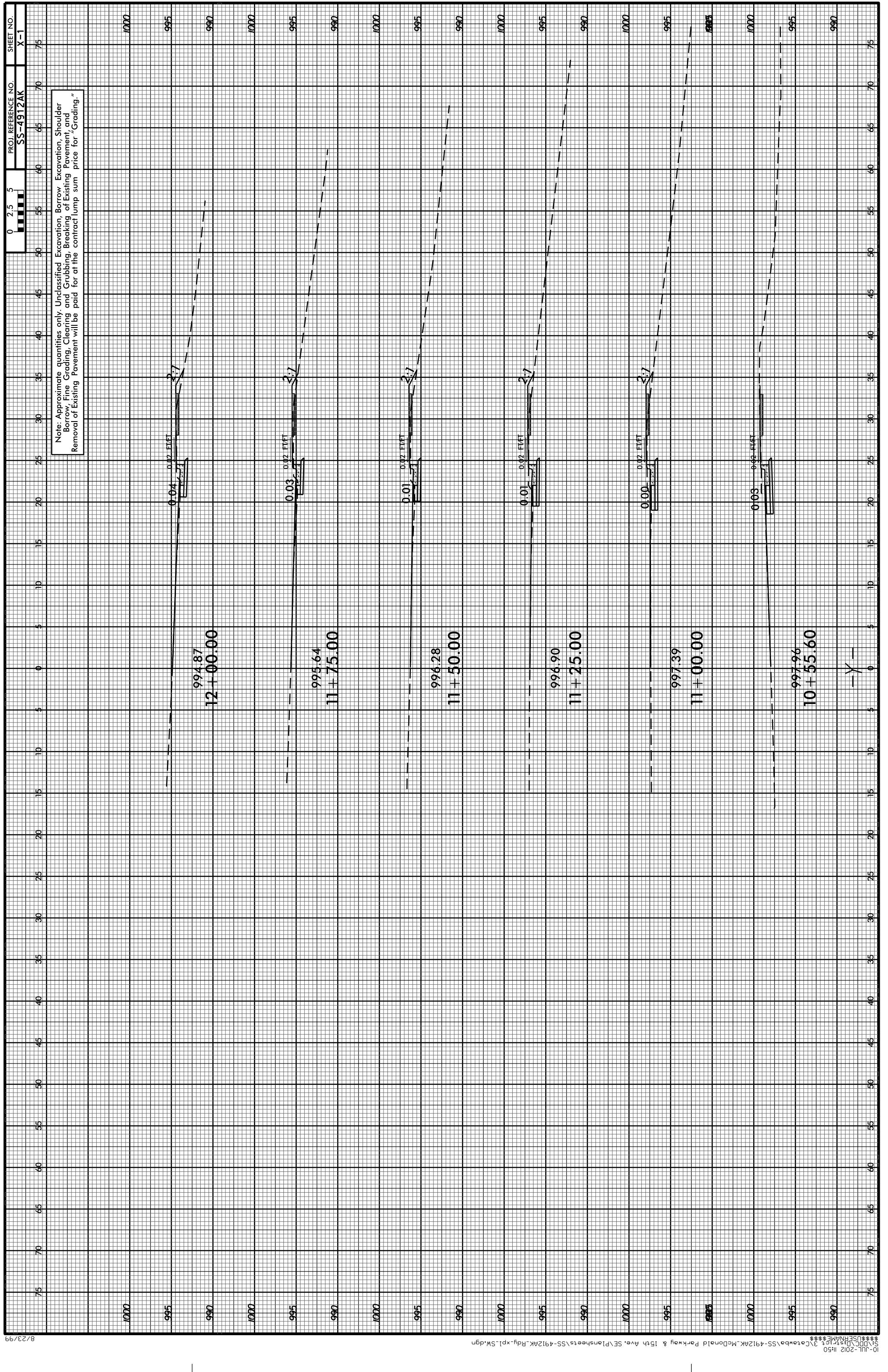

Note: Approximate quantities only. Unclassified Excavation, Borrow, Excavation, Shoulder Borrow, Fine Grading, Cleaning and Grubbing, Breaking of Existing Pavement, and Removal of Existing Pavement will be paid for at the contract lump sum price for Grading.

